

### SPECIFICATIONS

Suitable for ceiling or wall mounting and suspending  
ABS base and Polycarbonate cover

Voltage: 220 to 240V a.c. 50Hz  
Wattage: 50/70W  
Lamp Type: Epistar LED  
Luminaire Class: Class 1  
Lumen Output: 5000/7000 Lm  
Colour Temperature: 4000  
Degree of Protection: IP20 indoor only



### WIRING

L = Live or Phase – Brown or Red  
E = Earth – Green or Green/Yellow  
N = Neutral – Blue or Black

### DIMENSIONS

CODE	LENGTH (mm)	WIDTH (mm)	HEIGHT (mm)
B1224	1200	200	68
B1524	1500	200	68

### SAFETY

This product should be installed by a suitably qualified person in accordance with Australian and New Zealand Wiring rules. Always disconnect the power to the fitting before opening the cover. In the case of lamp failure, disconnect from mains supply and return to Vynco for service.

### WARRANTY

This product is covered by the standard 5 year Vynco Warranty - proof of purchase is required. Please contact Vynco for details of returns procedure.

NOTE: This product contains NO user serviceable parts.

THIS IS A CLASS I PRODUCT AND MUST BE EARTHED

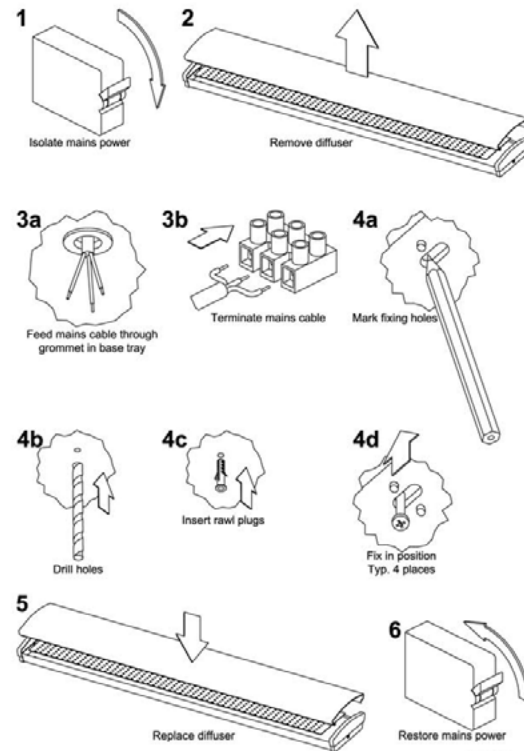

IS DRG. Iss. 1